

FINISHES

Standard finishes are:

STEEL Bright Steel, zinc chromate and florentine HINGES bronze, (zinc chromate and florentine bronze are factory applied cosmetic only finishes on zinc). Special finishes such as powder coating (various colours), baked enamel (any colour), brass plating, satin chrome, nickel etc., can be supplied to order.

BRASS Self colour lightly polished. Brass hinges can HINGES be supplied to order in the rumbled condition or a highly polished version.

MATERIALS

Hinges are manufactured from materials complying to the following specifications:

- STEEL** Material to ASTM 109M-83
Chemical Properties to AISI 1023
Mechanical Properties - HRB 70-85
- BRASS** Material to ASTM 836 - Alloy No. 8
Chemical composition - Copper 64-08.5%
Lead 0.15% max
Iron 0.05% max
Zinc Balance
Mechanical Properties - HRB 57-74

STANDARD PRODUCTS

Hinge Series	Size 'A' In Inches	Width 'B' In Inches	Material Thickness 'T' In Inches	Holes in each Hinge	Recommended Screw Gauge	Finish	Hinge Pin Material	Special Features	Hinge Series	Size 'A' In Inches	Width 'B' In Inches	Material Thickness 'T' In Inches	Holes in each Hinge	Recommended Screw Gauge	Finish	Hinge Pin Material	Special Features	
814	1"	2-29/32	.048	6	5	Bright Steel	Steel	-	2"	1-3/16	.048	4	5	Bright Steel	Steel	-		
	1 1/2"	3-3/8	.064	6	7	Bright Steel Florentine Bronze	Steel Brass	- -		2 1/2"	1-5/16	.048	6	5	Bright Steel Brass Florentine Bronze Zinc Plated	Steel Brass Brass Brass	- - - -	
808	3 1/2"	3-1/2	.104	6	10	Bright Steel Florentine Bronze Zinc Plated	Steel Brass Brass	- - -			333	3"	2	.064	6	7	Bright Steel Brass Florentine Bronze Zinc Plated	Steel Brass Brass Brass
	4"	4	.104	8	10	Bright Steel Brass Florentine Bronze Zinc Plated	Steel Brass Brass Brass	- - - -		3"		2-1/4	.080	6	9	Bright Steel Florentine Bronze Zinc Plated	Steel Brass Brass	- - -
804	3 1/2"	3-1/2	.104	6	10	Bright Steel Zinc Chromate Florentine Bronze Zinc Plated Zinc Plated	Steel Steel Steel Steel Steel	- - - - -				4"	2-7/8	.080	8	9	Bright Steel Brass Florentine Bronze Zinc Plated	Steel Brass Brass Brass
	4"	4	.104	8	10	Bright Steel Brass Zinc Chromate Florentine Bronze Zinc Plated Zinc Plated	Steel Brass Steel Steel Steel Steel	- - - - - -		1000	45mm		Refer Sketch		4	5	Florentine Bronze	Steel
3000	2 1/2"	1	.048	5	5	Florentine Bronze	Steel	Radius		2000	50mm	Refer Sketch		5	5	Florentine Bronze	Steel	-
5000	1"	7/8	.028	4	2	Bright Steel Florentine Bronze	Steel	-		1840	3"	2	.064	6	9	Bright Steel Brass Zinc Chromate Zinc Chromate Florentine Bronze Zinc Plated Zinc Plated	Steel Brass Steel Steel Steel Steel Steel	- - - - - - -
	1 1/2"	1	.036	4	3	Bright Steel Brass Florentine Bronze Zinc Plated	Steel Brass Brass Brass	- - - -			3 1/2"	2-1/14	.080	6	9	Bright Steel Bright Steel Brass Brass Zinc Chromate Zinc Chromate Zinc Chromate Florentine Bronze Florentine Bronze Florentine Bronze Zinc Plated Zinc Plated Zinc Plated	Steel Brass Brass Brass Steel Steel Steel Steel Steel Steel Steel Steel	Radius - - - Radius - - - Radius - Unassembled Radius Un*
4"	2-7/8	.080	8	9	Bright Steel Brass Zinc Chromate Zinc Chromate Zinc Chromate Florentine Bronze Florentine Bronze Zinc Plated Zinc Plated Zinc Plated	Steel Brass Steel Steel Steel Steel Steel Steel Steel Steel	- - - - - - - - - - Radius - - - Radius - - - Radius											

*Radius Unassembled.



OVERLAY HINGES

NO. 1000

FOR CUPBOARD DOORS

Suits all standard Overlay doors up to 16mm thick that are not required to open much over 90°. (all dimensions are in millimetres)

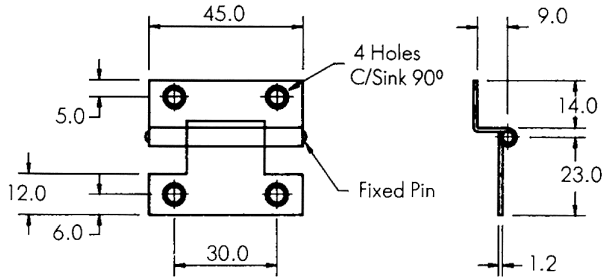

NO. 2000

FOR CUPBOARD DOORS

Suits most overlay situations. Allows the door to open 180°.

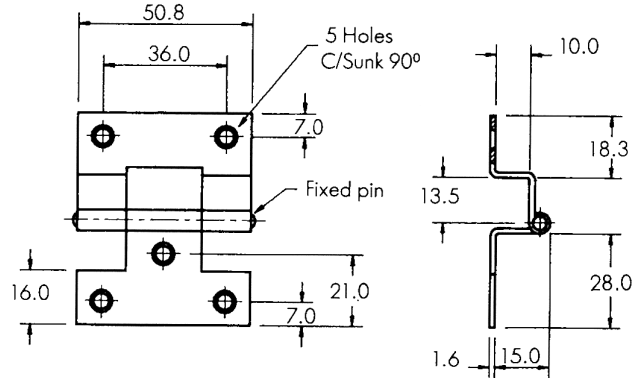

BROAD BUTTS

NO. 808 FIXED PIN BROAD BUTT HINGES

FOR EXTERIOR SECURITY DOORS OPENING UP TO 180°

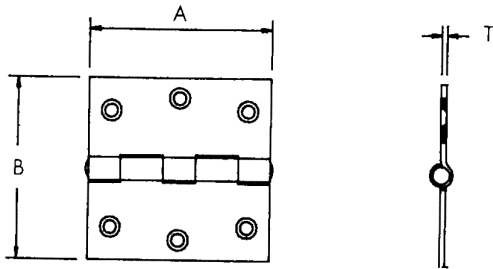

NO. 804

LOOSE PIN BROAD BUTT HINGES

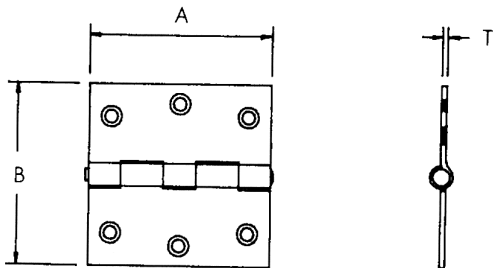

FLUSH BUTTS

NO. 3000

FIXED PIN FLUSH BUTT HINGES

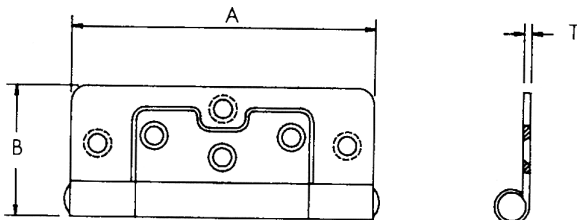

BUTT HINGES

NO. 5000 NARROW BUTT HINGES

FOR CUPBOARD DOORS

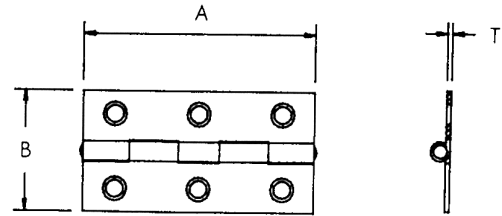

NO. 333 FIXED PIN BUTT HINGES FOR SECURITY DOORS, WINDOWS

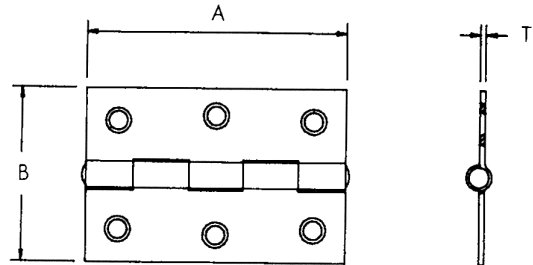

NO. 1840 LOOSE PIN BUTT HINGES FOR INTERIOR DOORS

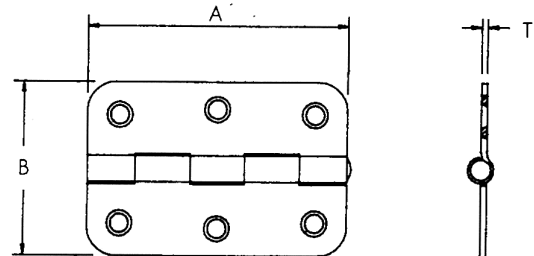

NO. 814 BACK FLAPS

