

# ULLRICH - HEATSINKS

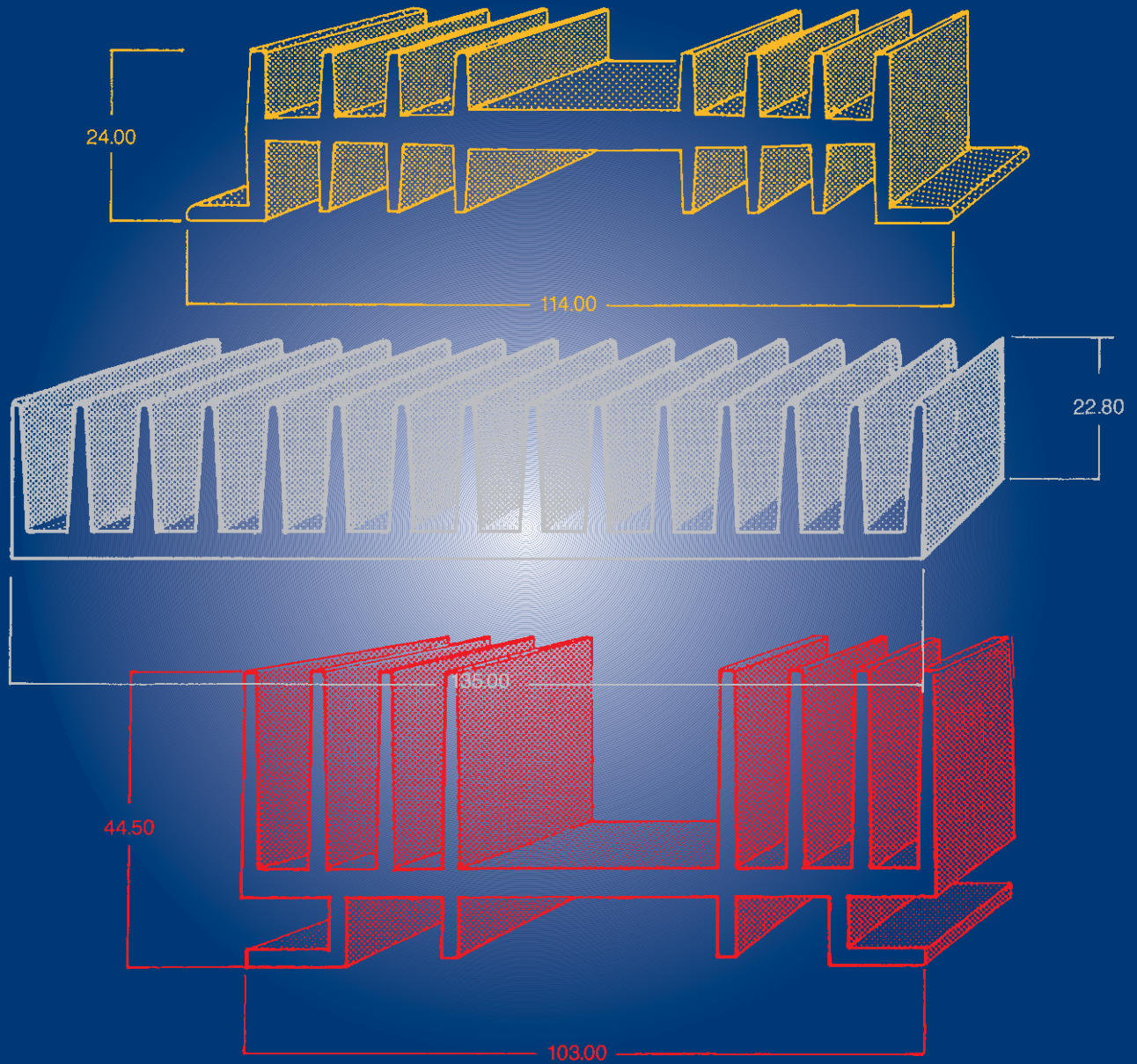



## HEAT SINK ALUMINIUM PRODUCTS

This is the first edition of our Heat Sink range of extrusions condensed into one catalogue.

We have endeavoured to reproduce the drawings as true to actual size as possible and included all dimensions.

Ullrich Aluminium does not offer all of the included Heat Sinks on an ex stock basis and some are subject to a minimum production run equivalent to 250kg per Heat Sink. We suggest you contact our Sales Centre nearest to you for availability of Heat Sinks. Refer to the back cover of this catalogue for an Ullrich Sales Centre near you.

We reserve the right to change design or delete our products without prior notice.



## HEAT SINKS

UAI632	3
UAI633	3
UAI634	4
UAI982	4
UA2109	5
UA2175	5
UA2284	6
UA2630	6
UA2651	7
UA2880	7
UA2960	8
UA3133	8
UA3295	9
UA4248	9
UA4305	10
UA4321	10
UA4348	11
UA4574	11
UA4718	12
UA4756	12
UA4770	13
UA4956	13
UA4979	14
UA5073	14





UAI634

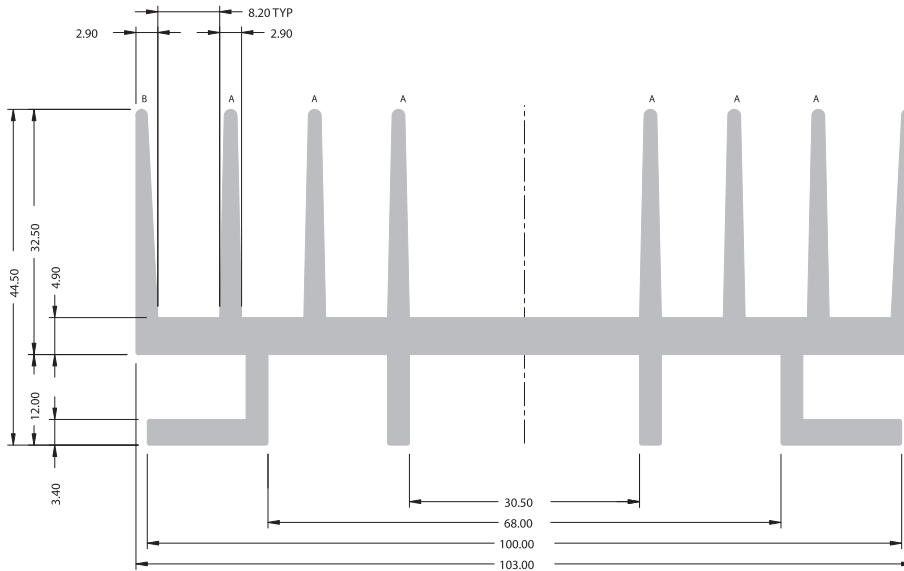

'A' DENOTES RAD R 0.75  
'B' DENOTES RAD R 0.85

UAI982

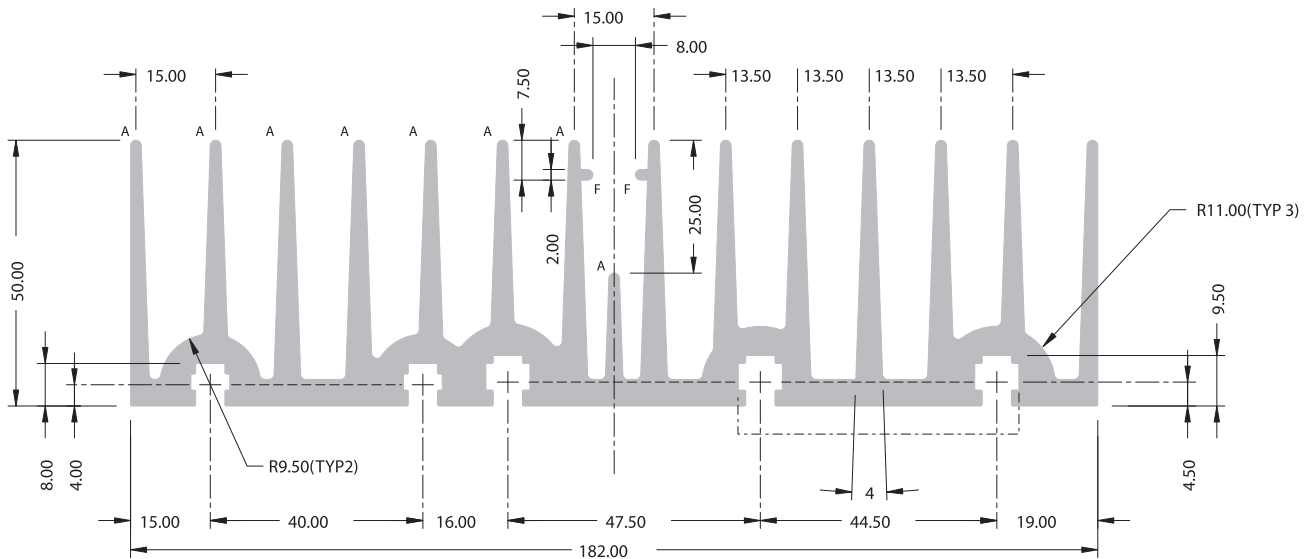

'A' DENOTES RAD R 1.00  
'F' DENOTES FULL RADII

ACTUAL SIZE NOT SHOWN



**UA2109**

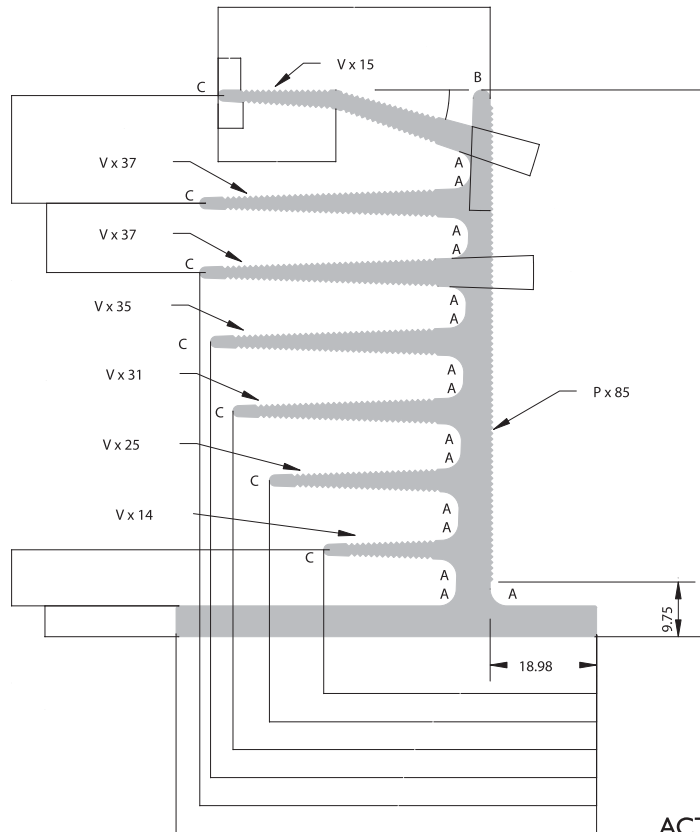

'A' DENOTES R3.00  
 'B' DENOTES R1.50  
 'C' DENOTES R1.00  
 'P' DENOTES VEE PIP 0.50 HIGH x 90±  
 'V' DENOTES VEE GROOVE 0.50 < 90

ACTUAL SIZE NOT SHOWN

**UA2175**

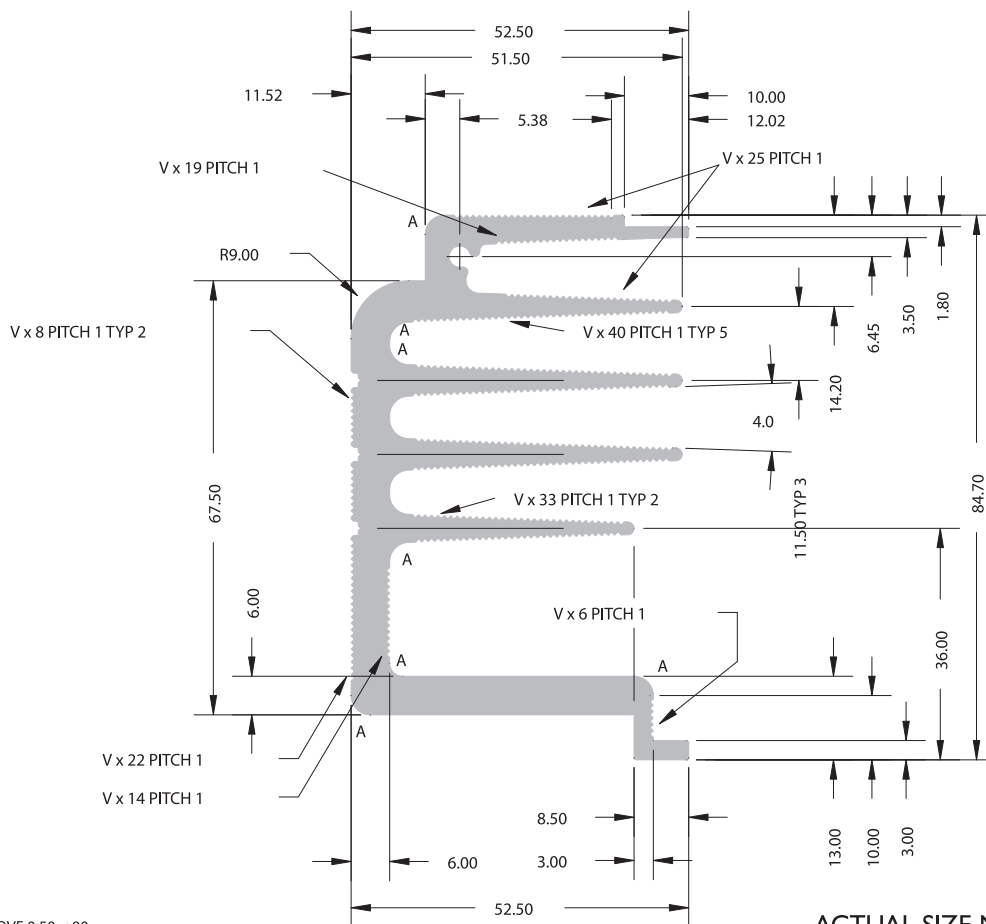

'A' DENOTES R 3.00  
 'B' DENOTES R 1.00  
 'C' DENOTES R 2.00  
 'D' DENOTES R 0.80  
 'V' DENOTES VEE GROOVE 0.50 < 90

ACTUAL SIZE NOT SHOWN



**UA2284**

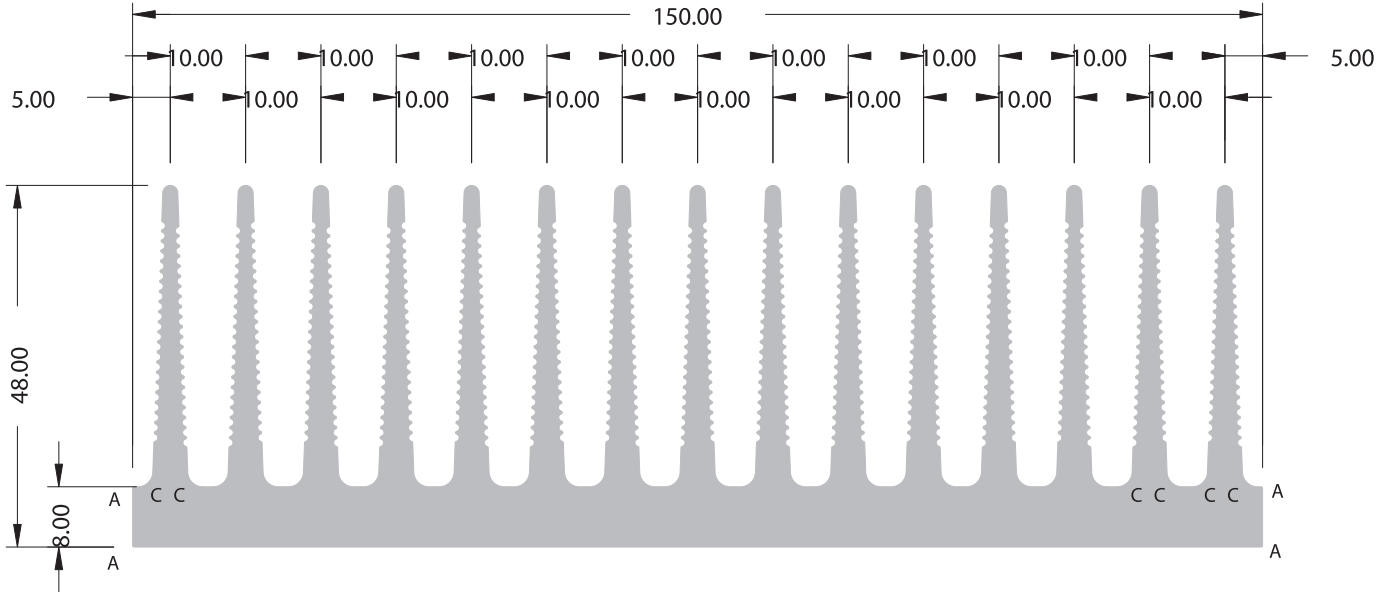

'A' DENOTES RAD R 0.20  
 'B' DENOTES RAD R 0.50  
 'C' DENOTES RAD R 2.00

**UA2630**

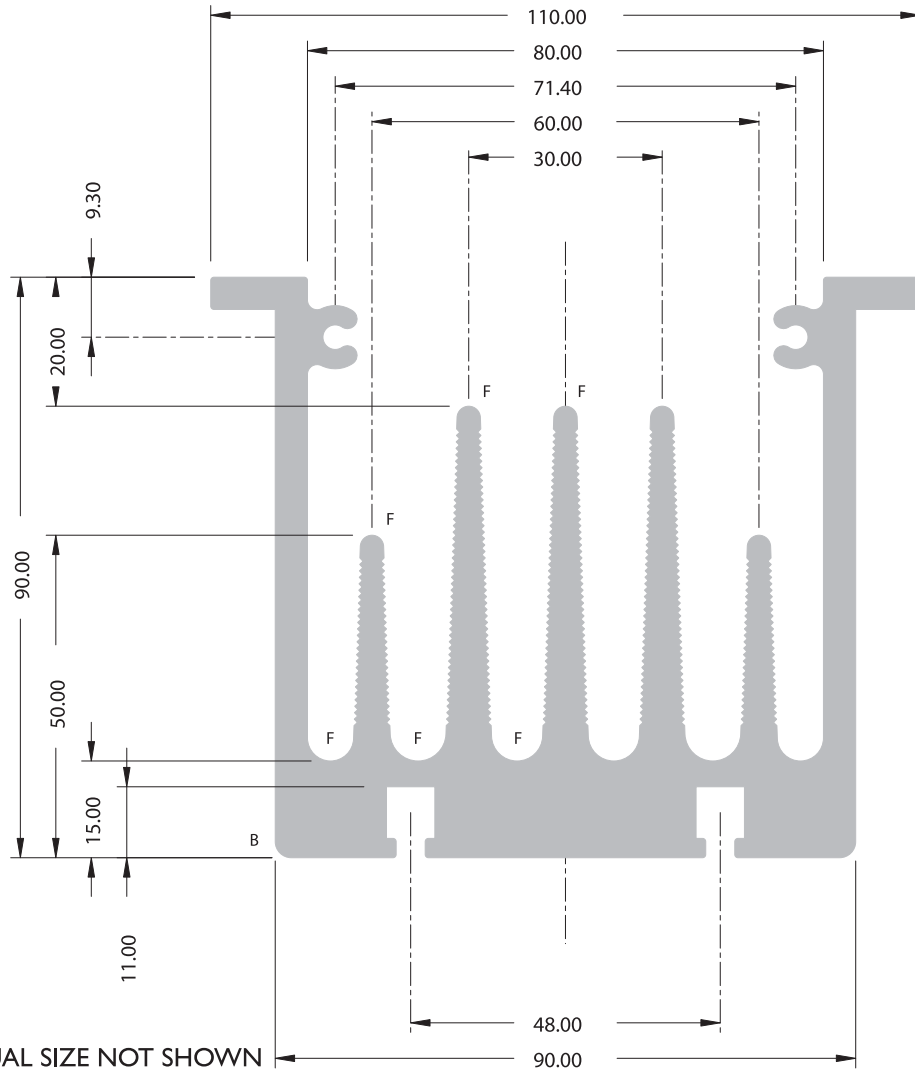

'A' DENOTES RAD R 1.50  
 'B' DENOTES RAD R 2.50  
 'F' DENOTES FULL RADII  
 'V' DENOTES VEE GROOVE 0.50 x 90

ACTUAL SIZE NOT SHOWN

UA265 I

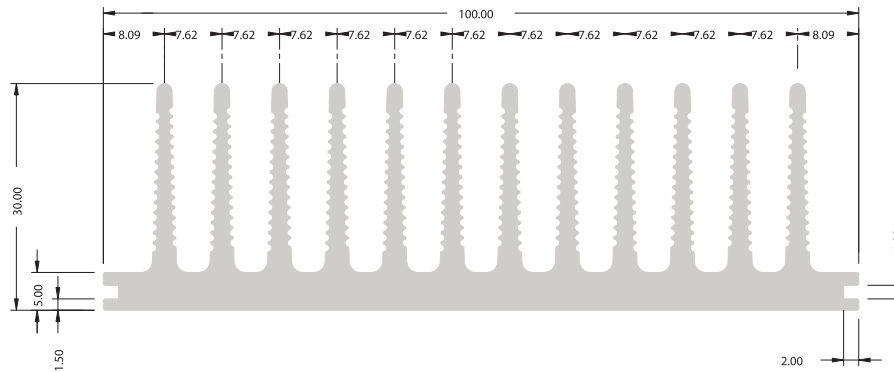

'A' DENOTES RAD R 0.20  
 'B' DENOTES RAD R 0.50  
 'C' DENOTES RAD R 1.50

UA2880

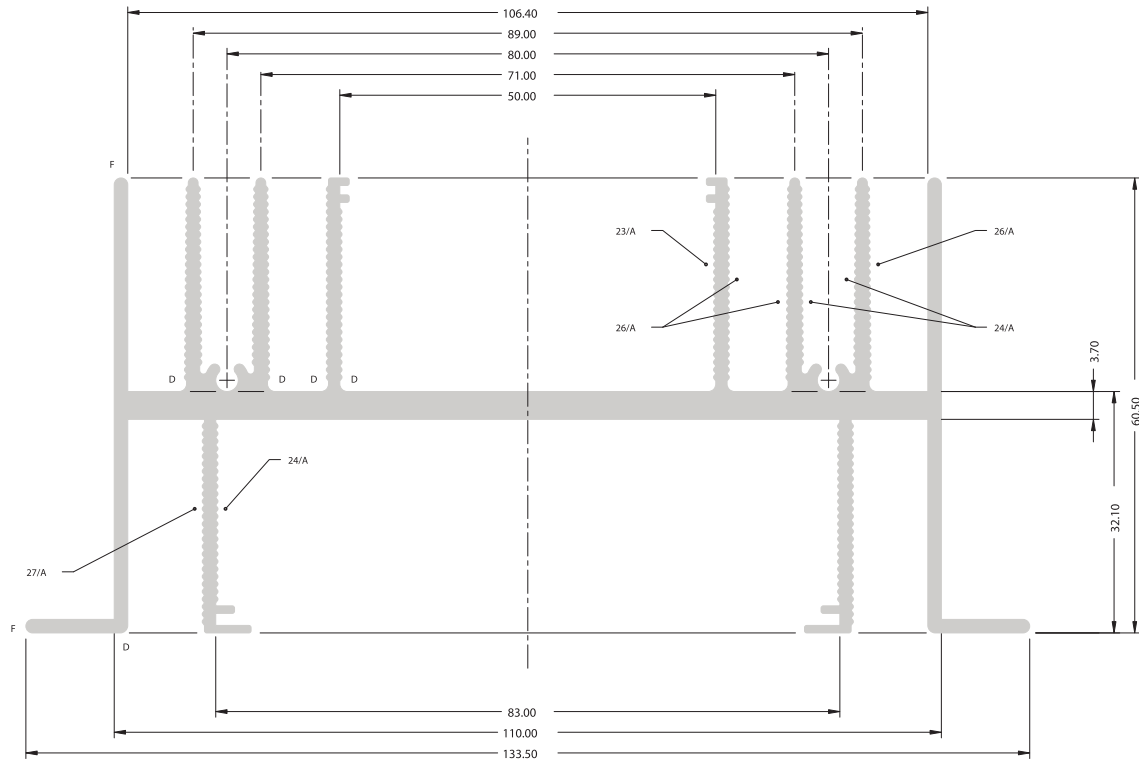

'A' DENOTES RAD R 0.30  
 'B' DENOTES RAD R 0.50  
 'C' DENOTES RAD R 0.65  
 'D' DENOTES RAD R 1.00  
 'F' DENOTES FULL RADII





UA2960

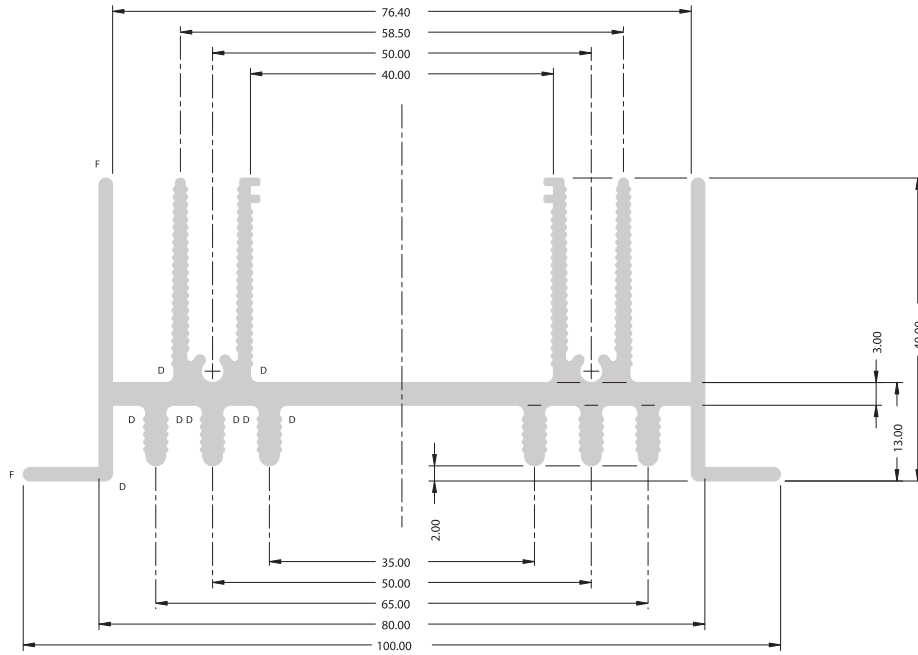

UA3133

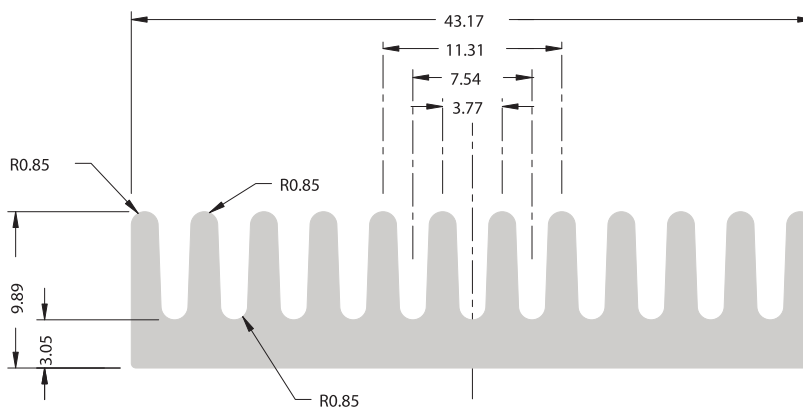

ACTUAL SIZE NOT SHOWN



**UA3295**

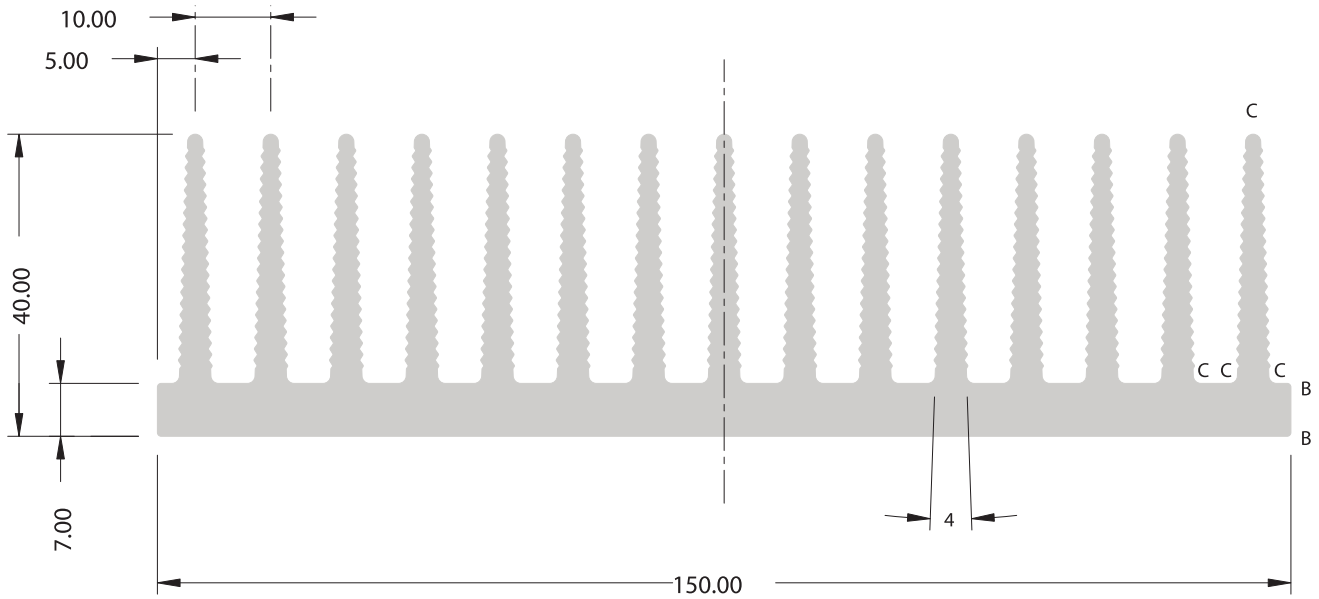

'A' DENOTES RAD R 0.20  
 'B' DENOTES RAD R 0.50  
 'C' DENOTES RAD R 1.00

**UA4248**

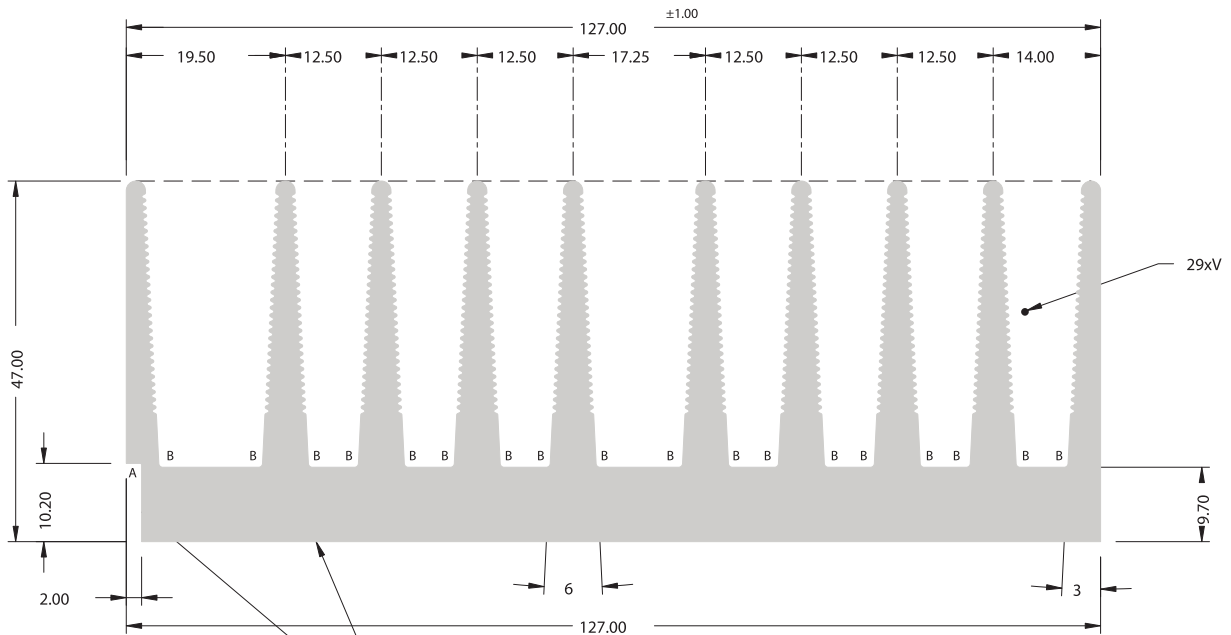

'A' DENOTES RAD R 0.20  
 'B' DENOTES RAD R 0.50  
 'C' DENOTES RAD R 1.25  
 'V' DENOTES VEE-GROOVE R 0.20 x 0.50 DEEP

**UA4305**

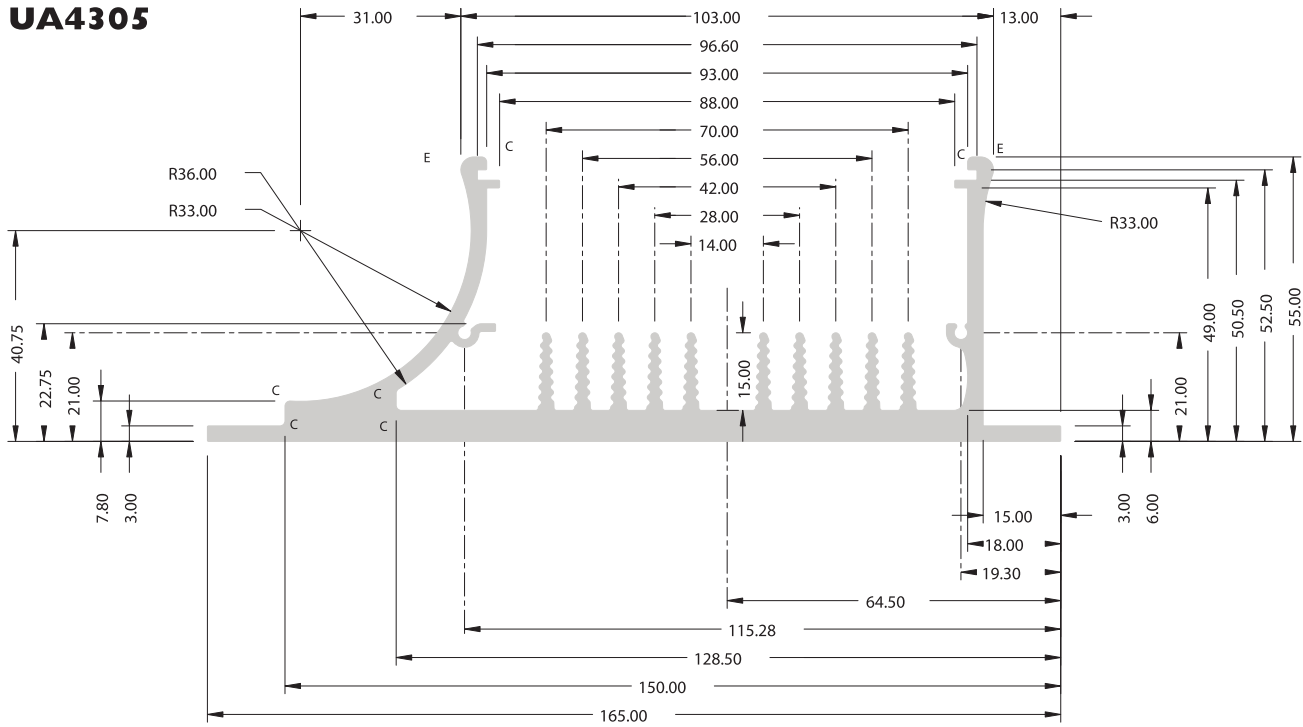

'A' DENOTES RAD R 0.50  
 'B' DENOTES RAD R 0.75  
 'C' DENOTES RAD R 1.00  
 'D' DENOTES RAD R 2.00  
 'E' DENOTES RAD R 2.50

ACTUAL SIZE NOT SHOWN

**UA4321**

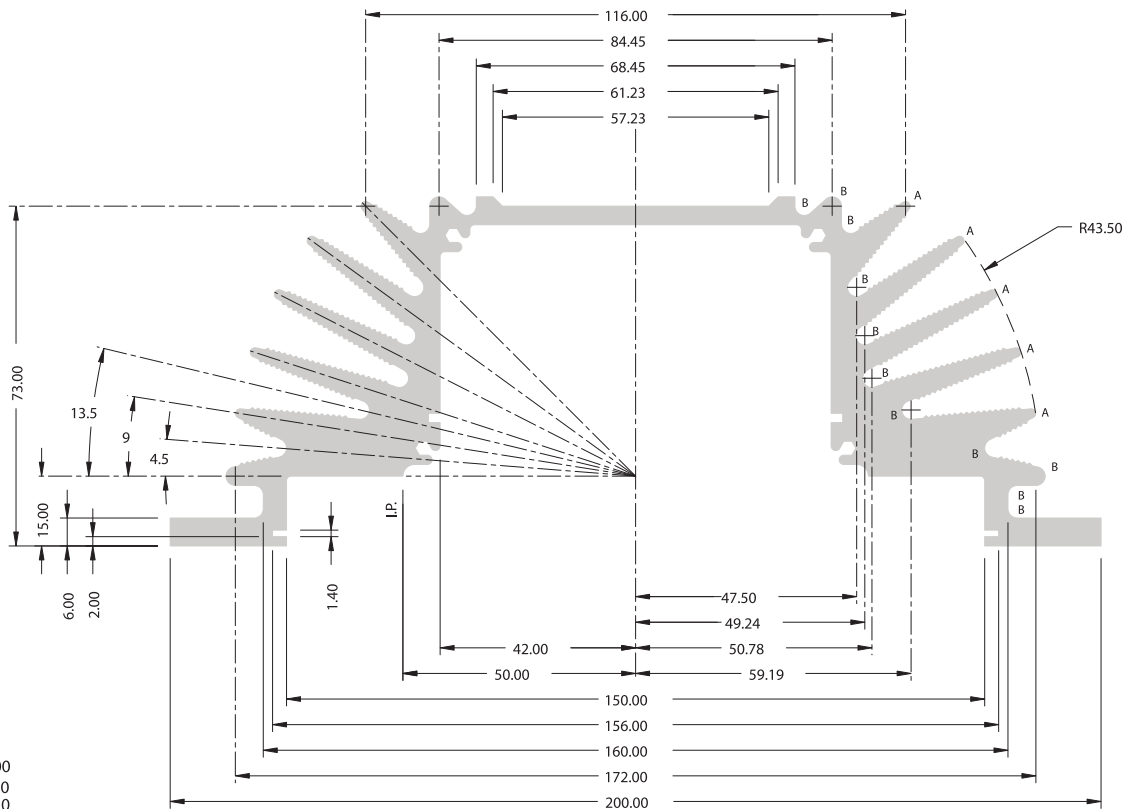

'A' DENOTES RAD R 1.00  
 'B' DENOTES RAD R 2.00  
 'C' DENOTES RAD R 2.50  
 'F' DENOTES FULL RADII  
 'P' DENOTES VEE-PIP 0.20 x 90

ACTUAL SIZE NOT SHOWN





UA4718

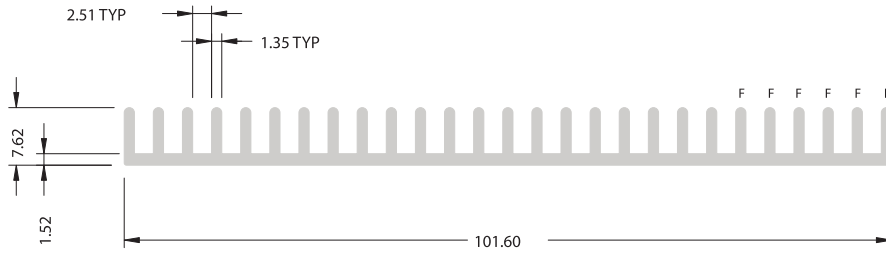

'F' DENOTES FULL RADII

UA4756

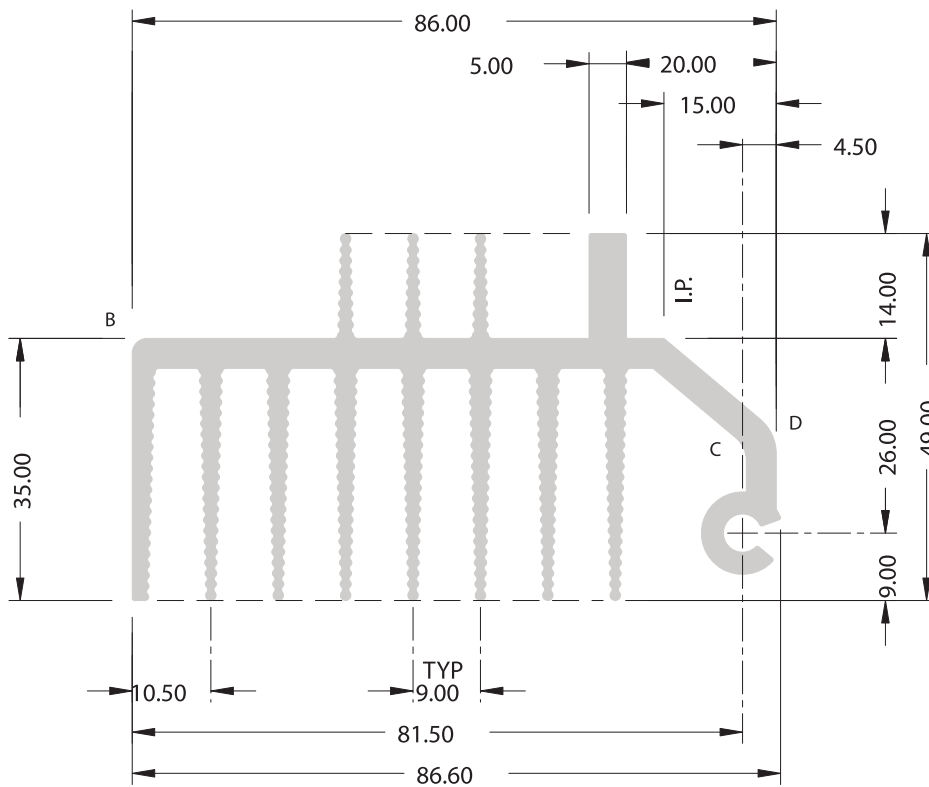

'A' DENOTES RAD R 0.50  
'B' DENOTES RAD R 2.00  
'C' DENOTES RAD R 4.00  
'D' DENOTES RAD R 6.00



**UA4770**

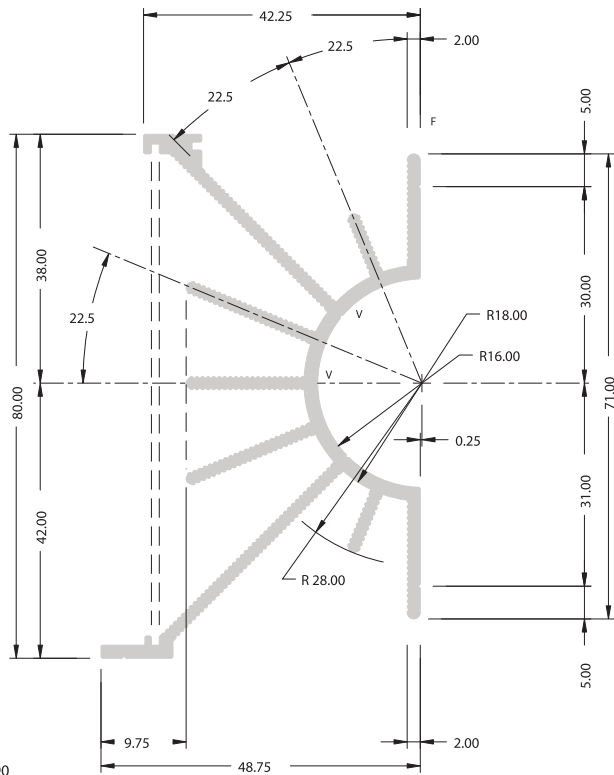

ACTUAL SIZE NOT SHOWN

**UA4956**

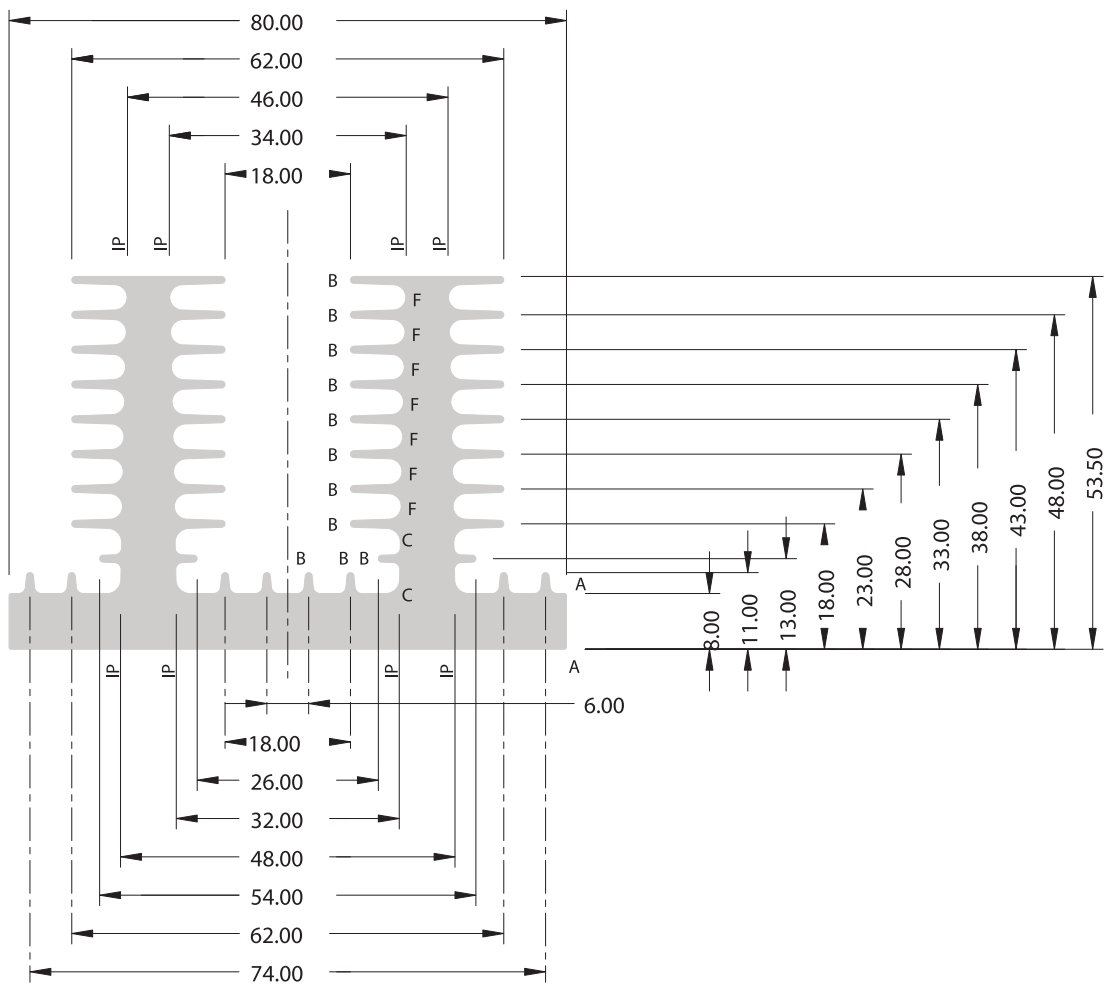

'A' DENOTES RAD R 0.30  
 'B' DENOTES RAD R 0.50  
 'C' DENOTES RAD R 2.00  
 'F' DENOTES FULL RADII



**UA4979**

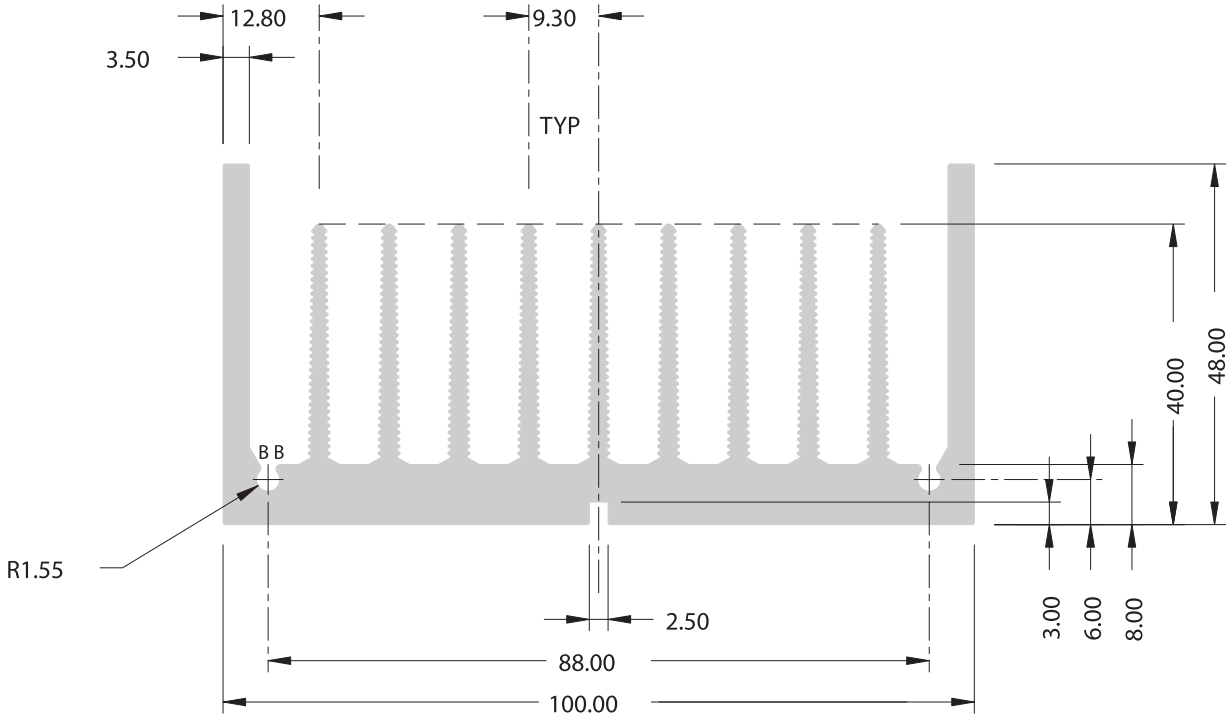

'A' DENOTES RA R 0.20  
 'B' DENOTES RAD R 0.50  
 'C' DENOTES RAD R 0.60

**UA5073**

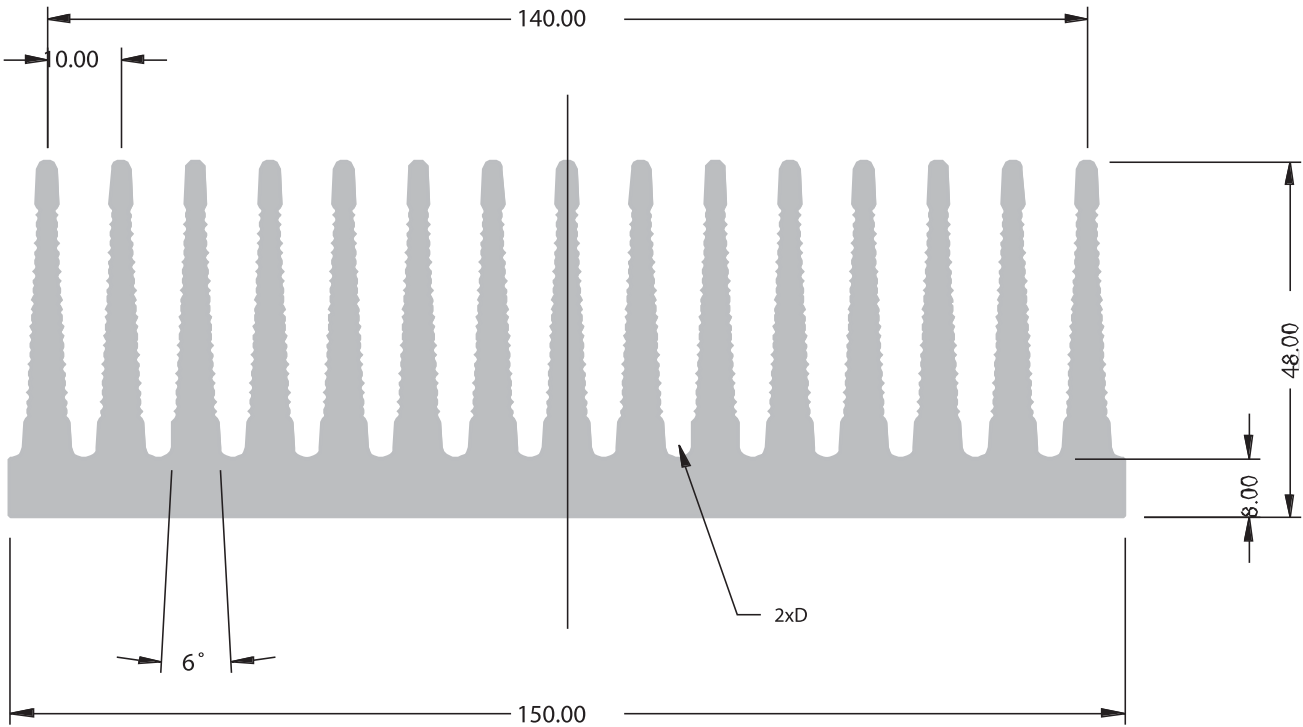

'A' DENOTES RAD R 0.30  
 'B' DENOTES RAD R 0.50  
 'C' DENOTES RAD R 1.00  
 'D' DENOTES RAD R 1.50

ACTUAL SIZE NOT SHOWN

# PLANNING GRID AND NOTES

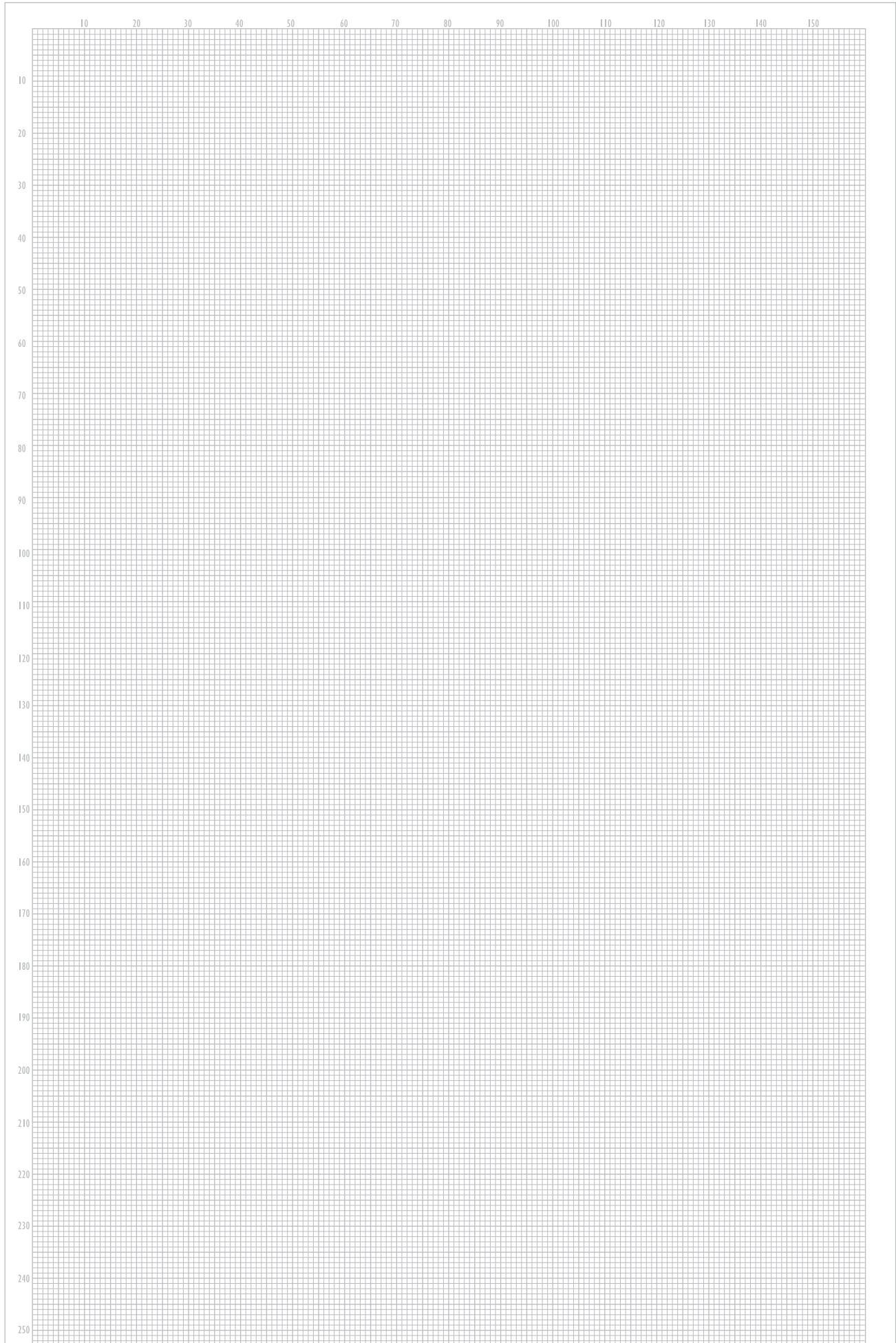



# CORROSION CHART



CHEMICAL	COLD	WARM	HOT	CHEMICAL	COLD	WARM	HOT
Acetone	R	R	R	Hydrogen Sulphide Wet	R	R	R
Aluminium Chloride Solution	NR	NR	NR	Lactic Acid 10%	R	F	NR
Anhydrous Aluminium Chloride	R	R	R	Lead Acetate 5%	NR	NR	NR
Aluminium Sulphate	R	R	R	Magnesium Hydroxide	NR	NR	NR
Ammonium Chloride 10%	F	F	NR	Magnesium Chloride 1%	R	F	NR
Ammonium Hydroxide	F	F	F	Magnesium Nitrate 5%	R	-	-
Ammonium Phosphate	F	F	NR	Nickel Chloride	NR	NR	NR
Ammonium Sulphate	F	-	-	Nitric Acid 15%	R	F	F
Ammonium Thiocyanate	R	R	R	Oleic Acid	R	R	F
Amyl Acetate	R	-	-	Oxalic Acid 10%	R	F	NR
Amyl Alcohol	R	R	R	Phenol CP	R	F	R
Arsenic Acid	F	F	F	Phosphoric Acid 50%	NR	NR	NR
Barium Chloride	F	F	NR	Potassium Bromide 100%	R	F	NR
Barium Sulphate	R	R	R	Potassium Carbonate 100%	F	F	-
Barium Sulphide	NR	NR	NR	Potassium Chloride 5%	R	R	R
Benzene	R	R	R	Potassium Hydroxide 50%	NR	NR	NR
Benzoic Acid	F	F	NR	Potassium Dichromate	R	R	R
Boric Acid	R	R	F	Potassium Nitrate 50%	R	R	R
Bromine Liquid or Vapour	NR	NR	NR	Potassium Sulphate 5%	R	R	R
Butyl Acetate	R	R	R	Propyl Alcohol	R	R	R
Butyl Alcohol	R	R	R	Sodium Acetate 20%	R	F	F
Butyric Acid	F	F	F	Sodium Bisulphite 10%	R	F	F
Calcium Chloride	F	F	NR	Sodium Borate	R	F	F
Calcium Hydroxide	R	-	-	Sodium Carbonate 18%	R	F	F
Calcium Hypochlorite 2-3	F	-	-	Sodium Chloride 5%	R	R	R
Calcium Sulphate	R	-	-	Sodium Hydroxide 20%	NR	NR	NR
Carbon Monoxide Gas	R	R	R	Sodium Hypochlorite 5%	R	F	F
Carbon Tetrachloride	F	F	NR	Sodium Nitrate 100%	R	R	R
Chloroform Dry	NR	NR	NR	Sodium Nitrite 100%	R	R	R
Chloroform Solution	R	NR	NR	Sodium Sulphate 100%	R	R	F
Chromic Acid 10% CP	R	R	-	Sodium Thiosulphate	R	R	R
Citric Acid	F	F	F	Sulphur Dioxide	R	R	R
Copper Cyanide	NR	NR	NR	Sulphuric Acid 5%	F	F	-
Copper Sulphate 5%	NR	NR	NR	Sulphuric Acid 10%	F	F	-
Ethyl Alcohol	R	R	R	Sulphuric Acid 50%	NR	NR	-
Ethylene Glycol	R	R	F	Sulphuric Acid 75-98%	NR	NR	-
Ferric Chloride	NR	NR	NR	Sulphuric Acid 98-100%	R	F	-
Ferrous Sulphate 10%	R	NR	NR	Tannic Acid 10% & 50%	R	R	R
Formaldehyde 37%	R	-	-	Tartaric Acid 10% & 50%	F	F	F
Formic Acid 10%	NR	NR	NR	Vinegar	F	F	F
Gallic Acid 5%	R	R	R	Zinc Chloride 5% & 20%	F	NR	NR
Hydrochloric Acid 25%	NR	NR	NR	Zinc Nitrate	F	F	NR
Hydrofluoric Acid 10%	NR	NR	NR	Zinc Sulphate	R	F	NR
Hydrogen Peroxide 30%	R	R	R				

The corrosion data given in this table is for general comparison only.

The presence of contaminants in chemical environments can greatly affect the corrosion rate of any metal.

Ullrich Aluminium can offer technical advice on any applications and is able to carry out environmental corrosivity evaluations of actual site conditions in order to determine the suitability of aluminium in any application if necessary.

R	= Recommended	Cold	= 10-30°C
F	= May be used in some conditions	Warm	= 55-75°C
NR	= Not Recommended	Hot	= 95-100°C
-	= Information not available		



Phone for your nearest  
**ULLRICH ALUMINIUM SALES CENTRE**

**AUSTRALIA - 1300 650 075**

**NEW ZEALAND - 0800 500 338**

- ALUMINIUM EXTRUSIONS
- ROLLED PRODUCTS
- FASTENINGS
- LADDERS
- SCAFFOLDS
- ULLTRACLAD CLADDING
- WINTEC WINDOWS & DOORS
- BUILDING PRODUCTS
- DECORATIVE METALS
- TEKNA MACHINERY

**Map key:**  
 + MANUFACTURING  
 ● SALES & DISTRIBUTION  
 \* EXTRUSION PLANT

Representative and franchised operations throughout the South Pacific

ULLRICH ALUMINIUM PTY LTD  
 PO Box 2182 Smithfield NSW 2164  
 185-187 Woodpark Rd Smithfield Australia  
 Tel +61 2 8787 7400 Fax +61 2 9725 2784  
 ullrich@ullrich.com.au www.ullrich.com.au

ULLRICH ALUMINIUM CO LTD  
 PO Box 98 843 SAMC  
 Manukau City 2240 New Zealand  
 Tel +64 9 262 6262 Fax +64 9 262 6265  
 alkalum@uacl.co.nz www.ullrich-aluminium.co.nz